

QUALITY TECHNOLOGIES

OPTOELECTRONICS

T-1 3/4 (5mm)

PART NO.	COLOR	VF	mcd	mA	DIM A in. (mm)
MV60538.MP7	RED	1.7	2.0	20	0.125 (3.18)
MV63538.MP7	YLW	2.1	18.0	20	0.125 (3.18)
MV64538.MP7	GRN	2.2	26.0	20	0.125 (3.18)
MV67538.MP7	HER	2.1	14.0	20	0.125 (3.18)
MV60539.MP7	RED	1.7	3.2	20	0.183 (4.65)
MV63539.MP7	YLW	2.1	20.0	20	0.183 (4.65)
MV64539.MP7	GRN	2.2	28.0	20	0.183 (4.65)
MV67539.MP7	HER	2.1	15.0	20	0.183 (4.65)

LOW CURRENT (2mA)

HLMP-47009.MP7	HER	1.8	2.0	2	0.183 (4.65)
HLMP-47199.MP7	YLW	1.9	2.0	2	0.183 (4.65)
HLMP-47409.MP7	GRN	1.9	3.0	2	0.183 (4.65)

AlGaAs RED

HLMP-D1019.MP7	RED	1.8	70.0	20	0.183 (4.65)
HLMP-D1509.MP7	RED	1.6	3.0	1	0.183 (4.65)

ULTRA BRIGHT

MV33509.MP7	YLW*	2.2	150.0	20	0.183 (4.65)
MV34509.MP7	GRN*	2.2	150.0	20	0.183 (4.65)
MV37509.MP7		2.2	150.0	20	0.183 (4.65)

INTEGRAL RESISTOR

MR30509.MP7		5.0	2.0	13	0.183 (4.65)
MR30519.MP7		12.0	2.0	13	0.183 (4.65)
MR33509.MP7	YLW	5.0	4.0	10	0.183 (4.65)
MR33519.MP7	YLW	12.0	4.0	13	0.183 (4.65)
MR34509.MP7	GRN	5.0	4.0	12	0.183 (4.65)
MR34519.MP7	GRN	12.0	4.0	13	0.183 (4.65)
MR37509.MP7		5.0	4.0	10	0.183 (4.65)
MR37519.MP7		12.0	4.0	13	0.183 (4.65)

BICOLOR

MV54919.MP7	G	2.3	6.0	20	0.183 (4.65)
-------------	---	-----	-----	----	--------------

All electrical values are typical
 *Clear lens



Figure 7

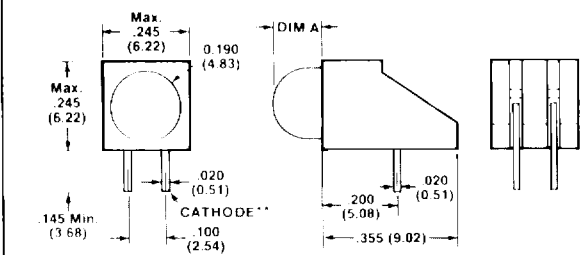

**THE CATHODE, AS INDICATED, IS THE RED CATHODE FOR THE RED/GREEN BICOLOR LED

DECIMALS = 0.015 (0.38)